



A/22 Piezo electric Accelerometer

26pC/g nom.

12gm wt.

250°C Max

The Konic sensing element of the A/22 incorporates a mechanically isolated central sleeve that comprises part of the transducer casing, proving and annular through whole attachment.

The feature allows 360° connector orientation and minimizes height, thus facilitating installation. In addition all welded construction and total absence of epoxies maximizes reliability, temperature range.

The A/22 provides an output comparable that of the A/20, with the advantage of 50% reduced height and total freedom of cable orientation.

A/22

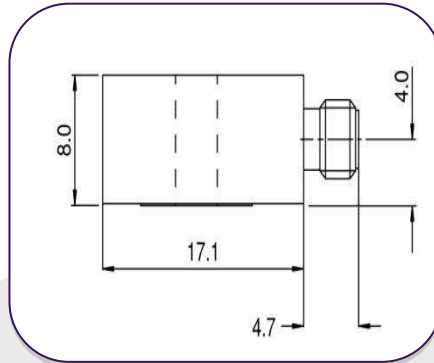

SI/22

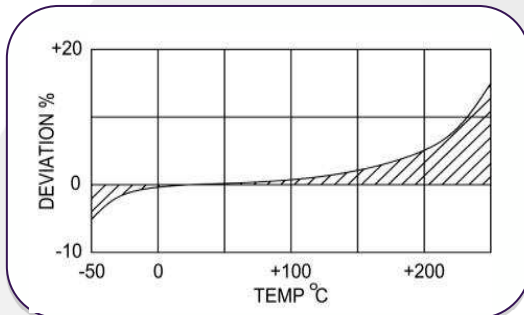
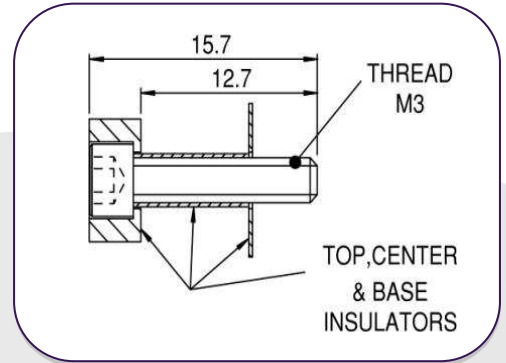

Temperature Response

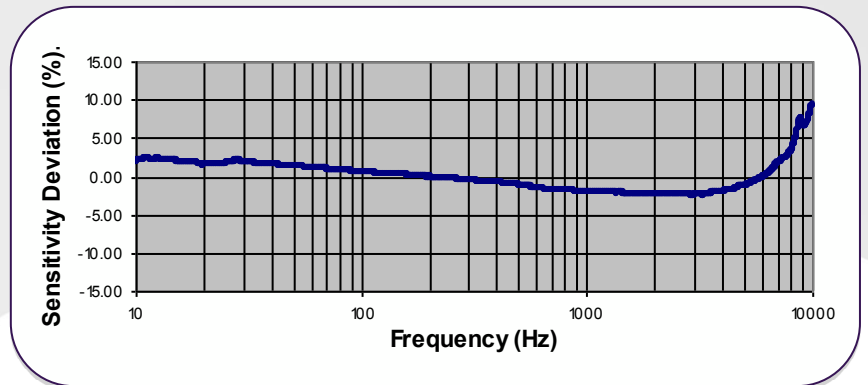

Typical Frequency Response

Options

- Close tolerance output. Wideband temperature calibration 50.C/250°C
- Hermetic connector not available
- Insulated mounting kit, SI/22 provides electrical isolation, minimising common mode interference

Conversion Mode	Konic
Charge sensitivity pC/g nom.	20-32
Capacitance	1300/1900
Resonant Frequency KHz	20
Cross Axis error % max	5
Temperature Range °C	-50/+250
Charge sensitivity deviation re 20 °C	-5% @ -50°C +15% @ +250°C
Frequency Range	1Hz – 10KHz, +/- 5%
Maximum 'g level	1000
Case Material	s/steel 303 S31
Connector	Microdot skt. 10/32 UNF thd.
Weight	12

CMV Steck GmbH

Rheinstraße 92

Tel: + 49 (0) 7275 988 684 - 0

www.CMV-Steck.de

D-76870 Kandel

Fax: + 49 (0) 7275 988 684 - 9

e-mail: info@CMV-Steck.de



ISO 9001:2008